

T501/502 DEADLOCK SERIES (EXPLODED DIAGRAM)

W1/4" THREADED TOP ROD (FOR 96" HEIGHT DOORS)
(INCLUDED IN T502T00)

W1/4" HEXAGONAL NUT
(INCLUDED IN T502)

W3/16" FLAT HEAD SCREW

FACEPLATE
(SEPARATE SALE)
FLAT/RADIUS
BEVEL RIGHT & LEFT

W5/32" GRUB SCREW

PARKER n°10 FLAT HEAD SCREW
(INCLUDED IN S501S00)

STRIKE (NIQUEL FINISH)
(INCLUDED IN S501S00)

M4 FLAT HEAD SCREW
(INCLUDED IN FACEPLATE)

MAIN CODES:

- T501DL DEADLOCK 1-1/2" BACKSET
- T501DM DEADLOCK 1-1/8" BACKSET
- T501HL HOOKLOCK 1-1/2" BACKSET
- T501HM HOOKLOCK 1-1/8" BACKSET
- T502T00 HEADER BOLT (TOP)
- T502B00 THRESHOLD BOLT (BOTTOM)
- T352E00 EXTENSION ROD FOR UP TO 120" HEIGHT DOORS

ACCESORIES:

- S501FXX FACEPLATE FLAT
- S501RXX FACEPLATE RADIUS
- S501BLXX FACEPLATE BEVEL LEFT
- S501BRXX FACEPLATE BEVEL RIGHT
- S501S00 DEADLOCK STRIKE

xx= FINISH 01-BLACK MATE 04- GREY 06- WHITE 12-DARK BRONZE

CYLINDERS: (use 1 1/8" length for 2" thickness and 1" length for 1 3/4") (for special thickness adjust with spacers)

- R503-01 Brass pair mortise cylinder 1" length(+2 trim ring)
- R503-02 Brass pair mortise cylinder 1 1/8" length(+2 trim ring)
- R503-03 Brass single mortise cylinder 1 1/8" length (+1 trim ring)
- R503-04 Brass single Thumb turn 1 1/8" length (+1 trim ring)
- I354-34 Spacer clear 1/8"
- I354-35 Spacer clear 1/16"

T502T00 HEADER BOLT (TOP)

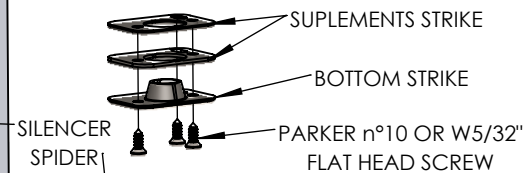

SILENCER
SPIDER

SUPLEMENTS STRIKE

BOTTOM STRIKE

PARKER n°10 OR W5/32"
FLAT HEAD SCREW

TOP BOLT
LOCK

M5 FLAT HEAD SCREW

W1/4" HEXAGONAL NUT

UPPER ARM
(INCLUDED IN T502T00)

TRIM RING

SPACER

MORTISE CYLINDER
(OR THUMBTURN)
ADDAMS RITE CAM

BOLT CONNECTION ARM
(INCLUDED IN T502)

CLIP RING
(INCLUDED IN T502)

DEADBOLT OR HOOKBOLT

BOTTOM ARM
(INCLUDED IN T502B00)

T502B00 THRESHOLD BOLT (BOTTOM)

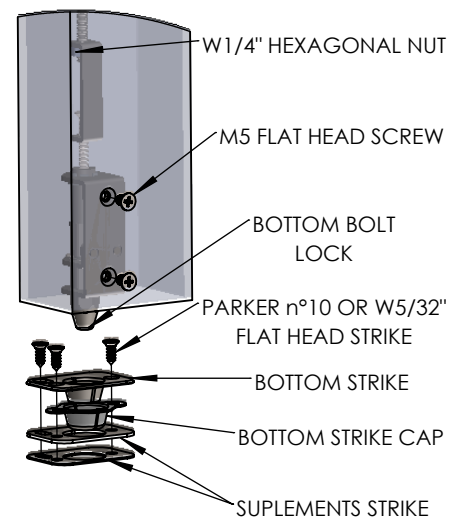

W1/4" HEXAGONAL NUT

M5 FLAT HEAD SCREW

BOTTOM BOLT
LOCK

PARKER n°10 OR W5/32"
FLAT HEAD STRIKE

BOTTOM STRIKE

BOTTOM STRIKE CAP

SUPLEMENTS STRIKE

1/4" THREADED TOP ROD
(FOR 40" STANDARD HEIGHT INSTALLATION)
(INCLUDED IN T502B00)

SILENCER SPIDER