

T705 / T707 ELECTRIC STRIKE (EXPLODED DIAGRAM)

EXP-18-T705

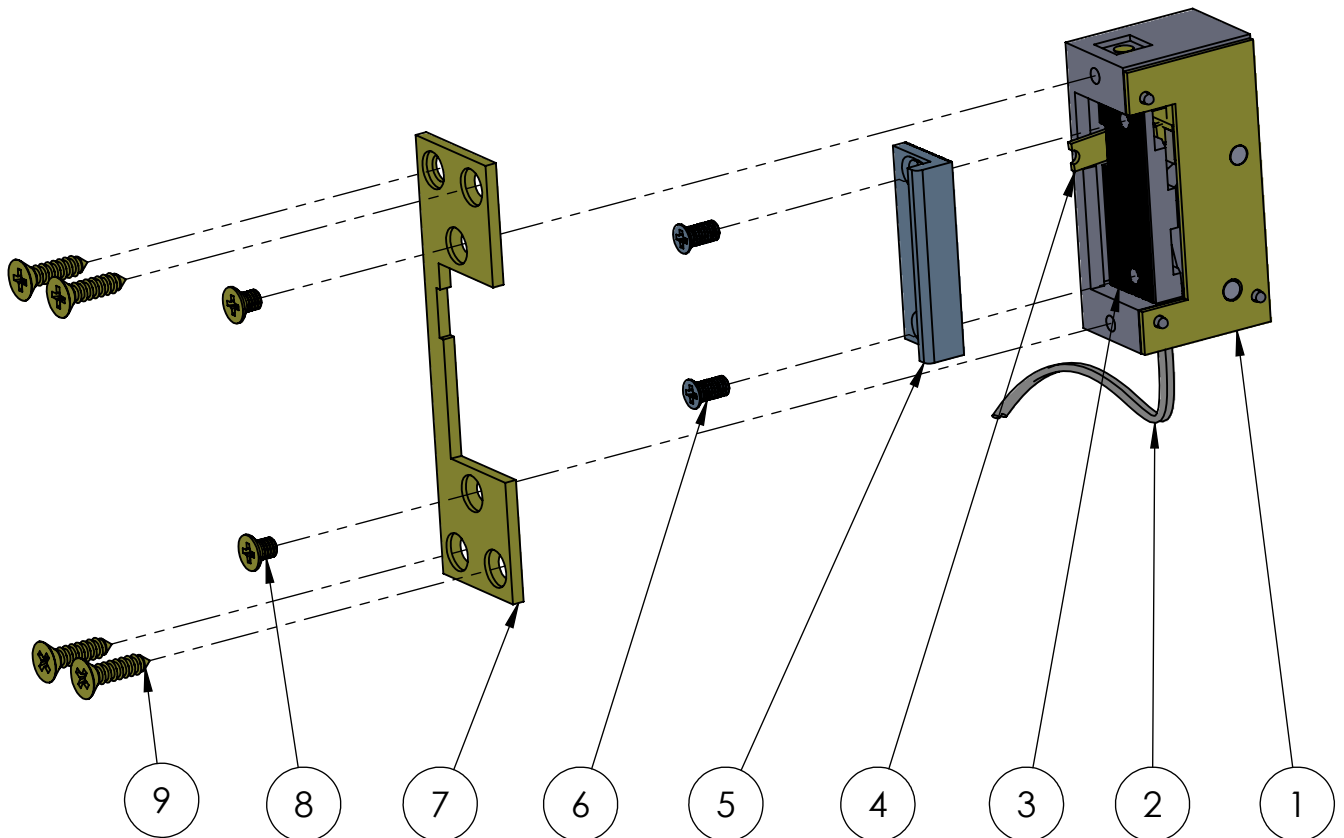

* ONLY FOR **T707-XX** MODELS

9	FIXING ELECTRIC LOCK TO DOOR FRAME SCREW	COMMERCIAL COUNTERSUNK HEAD PARKER #7 x 5/8"	YELLOW ZINC PLATED	4
8	FIXING FACEPLATE TO CASE ELECTRIC LOCK SCREW	COMMERCIAL COUNTERSUNK HEAD M4 x 6	YELLOW ZINC PLATED	2
7	FACEPLATE	SAE 1010 METAL SHEET	YELLOW ZINC PLATED	1
6	ADJUST AND FIXING KEEPER TO STRIKE PLATE SCREW	COMMERCIAL COUNTERSUNK SMALL HEAD M4 x 8	BLUE ZINC PLATED	2
5	KEEPER	ZAMAK 5	BLUE ZINC PLATED	1
4	RELEASE LEVER *	SAE 1010 METAL SHEET	YELLOW ZINC PLATED	1
3	STRIKE PLATE	ZAMAK 5	NATURAL	1
2	FEED CABLES	COMMERCIAL COOPER WIRE 1 x 0,16mm2 (AWG 25)	END TO SOLDER (TINNED)	2
1	ELECTRIC LOCK	ZAMAK 5 / SAE 1010 METAL SHEET	NATURAL / YELLOW ZINC PLATED	1
No.	PART. NAME	MATERIAL	FINISH	QTY

BILL OF MATERIAL (BOM)